



**** Ongoing Investment Opportunity ** Landlords Only ****

A traditional mid terrace home currently tenanted as a 4 bedroom Let Home. Being sold as an ongoing investment with tenants in occupation, this property offers an attractive rental yield in the heart of Burton on Trent close to Burton Hospital.

The home opens with a side entrance hallway, with a communal sitting room on the rear elevation leading to the modern fitted kitchen. The kitchen has built-in oven and hob, with further freestanding appliance spaces, wall mounted gas fired combination boiler and back door to the garden. The ground floor bathroom leads off from the kitchen and provides a WC, basin & bath with an electric shower above.

The front sitting room is currently used as a bedroom let @ £85 per week. The first floor has three further bedrooms, the two larger rooms occupied at £85 per week and the small bedroom, currently vacant, historically let at £75 per week. Total gross income potentially £18,000. The landlord is responsible for bills on the current agreements. With gas central heating and UPVC double glazing this home is an ideal investment.

The home has a good size rear garden with gated access to the front of the home. All viewings by appointment only.

01283 528020
NICHOLASHUMPHREYS.COM

The Accommodation

Hallway

Sitting Room
12'6 x 12'0

Kitchen
10'9 x 8'0

Ground Floor Bathroom
7'10 x 6'3

Front Room
12'6 x 11'8

First Floor

Bedroom Front
12'1 x 11'11

Double Bedroom Rear
12'11 x 11'9

Single Bedroom Rear
10'5 x 8'0

Rear Garden

Property construction: Standard

Parking: None

Electricity supply: Mains

Water supply: Mains

Sewerage: Mains

Heating: Mains Gas

Awaiting EPC Inspection

Council Tax Band: A

Local Authority: East Staffordshire Borough Council

Broadband type: TBC - See Ofcom link for speed:

<https://checker.ofcom.org.uk/> Mobile signal/coverage: See

Ofcom link <https://checker.ofcom.org.uk/>

Useful Websites:

www.gov.uk/government/organisations/environment-agency

Anti-Money Laundering (AML) Requirements

In line with the Money Laundering Regulations 2017, all purchasers and, where applicable, cash donors are required to complete AML identity and source-of-funds checks once an offer is accepted. These checks are carried out via "Thirdfort" and do not affect your credit rating. A non-refundable compliance fee of £36.00 including VAT applies per person (with an additional fee of £36.00 per individual/ cash donor). Full details are set out in our PDF brochure.

Please ensure you have viewed the agent's full PDF branded brochure for full information regarding the property and not rely on third party website information supplied before actioning the purchase process.

The property information provided by Nicholas Humphrey Estate Agents is based on enquiries made of the vendor and from information available in the public domain. If there is any point on which you require further clarification, please contact the office and we will be pleased to check the information for you. Please note if your enquiry is of a legal or structural nature, we advise you to seek advice from a qualified professional in their relevant field. The home is a multi room let with 4 rooms, not a HMO, and no licence has been obtained for the purpose of the home being used as a HMO.

Draft details awaiting vendor approval and subject to change





Ground Floor

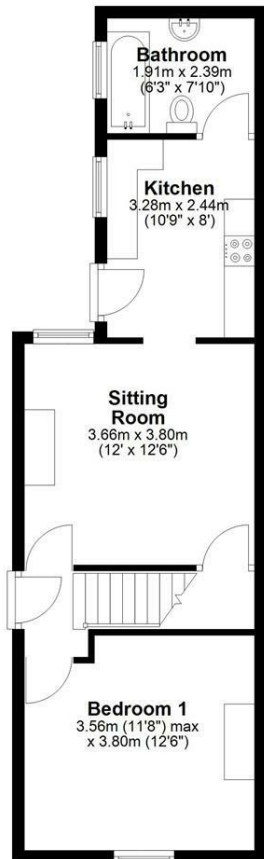

First Floor



NICHOLAS HUMPHREYS. This Floorplan is for illustrative purposes only and while reasonable efforts have been made to ensure its accuracy, it is not to scale and measurements should not be relied upon. For display and layout purpose only used by NICHOLAS HUMPHREYS, as a general indication of the layout. It does not form any part of any contract or warranty.
Plan produced using PlanUp.



Council Tax Band A Freehold

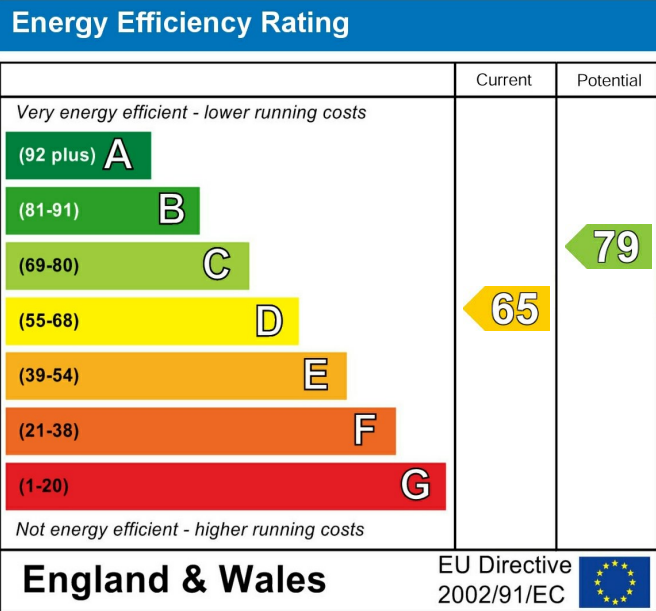

Important Notes, Charges & Selective Licence Areas

AML & ID Verification Checks & Charges. In accordance with our legal obligations under the Money Laundering Regulations 2017, and the Protecting Against Money Laundering and Proceeds of Crime Act 2002, we are required to carry out Anti-Money Laundering (AML) identity verification and source-of-funds checks on all purchasers and, where applicable, any third-party cash donors once an offer has been accepted on a property. We use "Thirdfort" to complete these checks. This process does not involve a credit check and will therefore have no impact on your credit history. With effect from 1st March 2026, a non-refundable compliance fee of £30.00 + VAT (£36.00 including VAT) will be payable per person, per transaction, covering AML checks for purchasers and/or cash donors. This fee must be paid in advance, once an offer is agreed and prior to a sales memorandum being issued.

Where there is more than one purchaser and/or cash donors, an additional fee of £36.00 including VAT per additional person will be required. The compliance fee is non-refundable, as the checks are undertaken immediately upon instruction and the associated costs are incurred regardless of whether the transaction proceeds to completion. This applies whether the sale or purchase falls through due to the actions of the purchaser, the vendor, or for any other reason.

Services. If & where stated in the details main's water, gas and electricity are understood to be available to the property, none of these have been tested or investigated for connection, nor any of the appliances attached thereto, have been tested by Nicholas Humphreys, who gives no warranties as to their condition or working order.

Floor Plans. To be used as an illustrative purpose only and while reasonable efforts have been made to ensure its accuracy, it is not to scale and measurements should not be relied upon. The company displays the floor plan as a general indication of layout and it does not form any part of any contract or warranty and provides an approximate guide to layout.

Survey. We advise all buyers to undertake their own investigations into the condition of the property and surroundings by an independent survey. We the Agent do not conduct a survey of the property and cannot advise on structural defects or materials used. Independent advice is required before exchange and completion.

Agent Note. Whilst every care has been taken in preparation of these details, they are for guidance purpose only. All measurements are approximate, and whilst every care has been taken for accuracy, their accuracy should not be relied upon. Buyers are advised to recheck measurements and inspect the property before exchange of contracts to confirm they are satisfied with the condition of the property and surroundings before completion of the purchase. New development sites are increasingly implementing an on-site annual management charge, all sale of property could be subject to this charge, to be verified & confirmed by your acting solicitor/ conveyancer before exchange of contracts.

Selective Licence Areas. The Council's Selective Licensing Scheme requires all landlords who privately rent out properties within the designated areas to obtain a licence from the council. Within Burton on Trent the following streets have been designated: Blackpool Street, Branston Road, Broadway Street, Goodman Street, King Street, Queen Street, Shobnall Street, Uxbridge Street & Waterloo Street. A license fee for application will be payable and work to the home maybe required. Full information: <https://www.eaststaffsbc.gov.uk/housing-and-property/landlords/selective-licensing-scheme>